

Size: 395 sq. miles
 Population: 1.2 million
 MS4 - Phase 1 Community

Chesapeake Bay Watershed

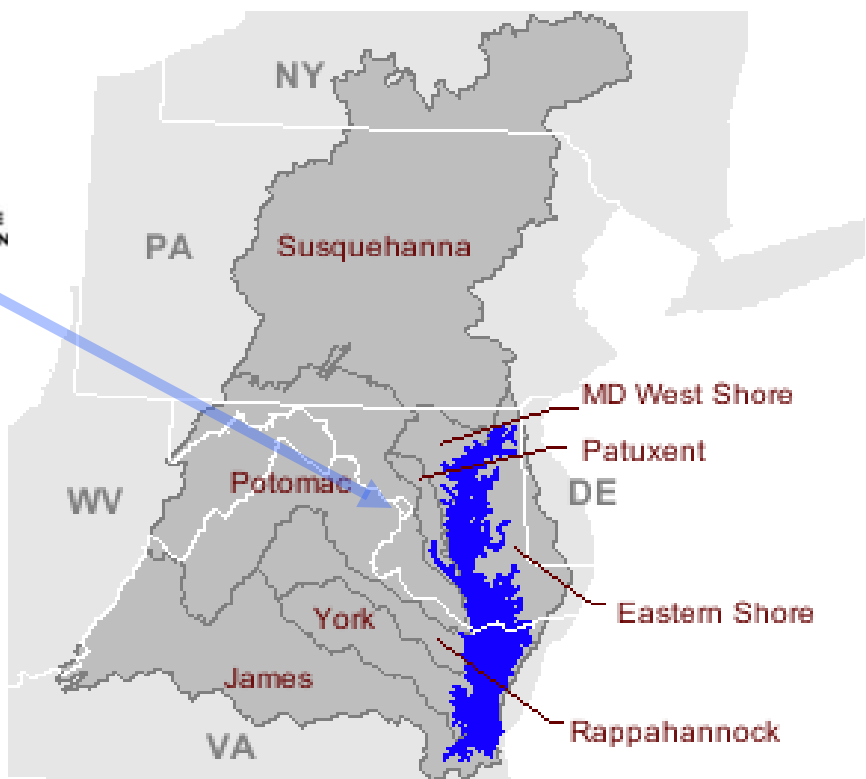

Green Street Discussion



- Green Street Projects
- Stormwater Ordinance
- Tysons Comprehensive Plan
- Future Considerations

Neighborhood Stormwater Improvement Project



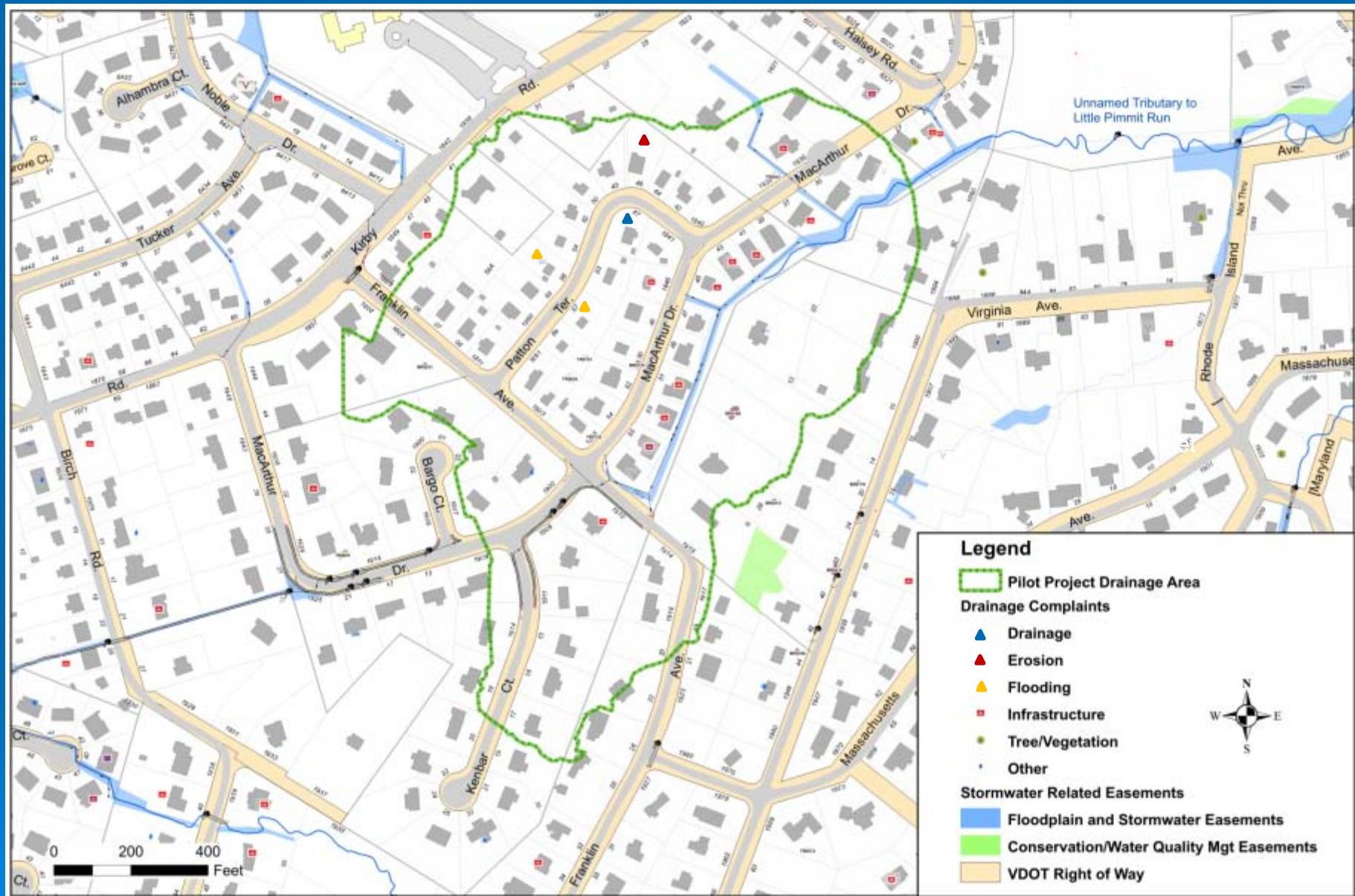

Pilot Project Drainage Area = 34 Acres

Design Goals

- ✓ Reduce flooding and erosion
- ✓ Collect runoff at the source
- ✓ Improve water quality
- ✓ Improve tributary stability
- ✓ Use innovative & functional designs
- ✓ Make it aesthetic



Critical Areas

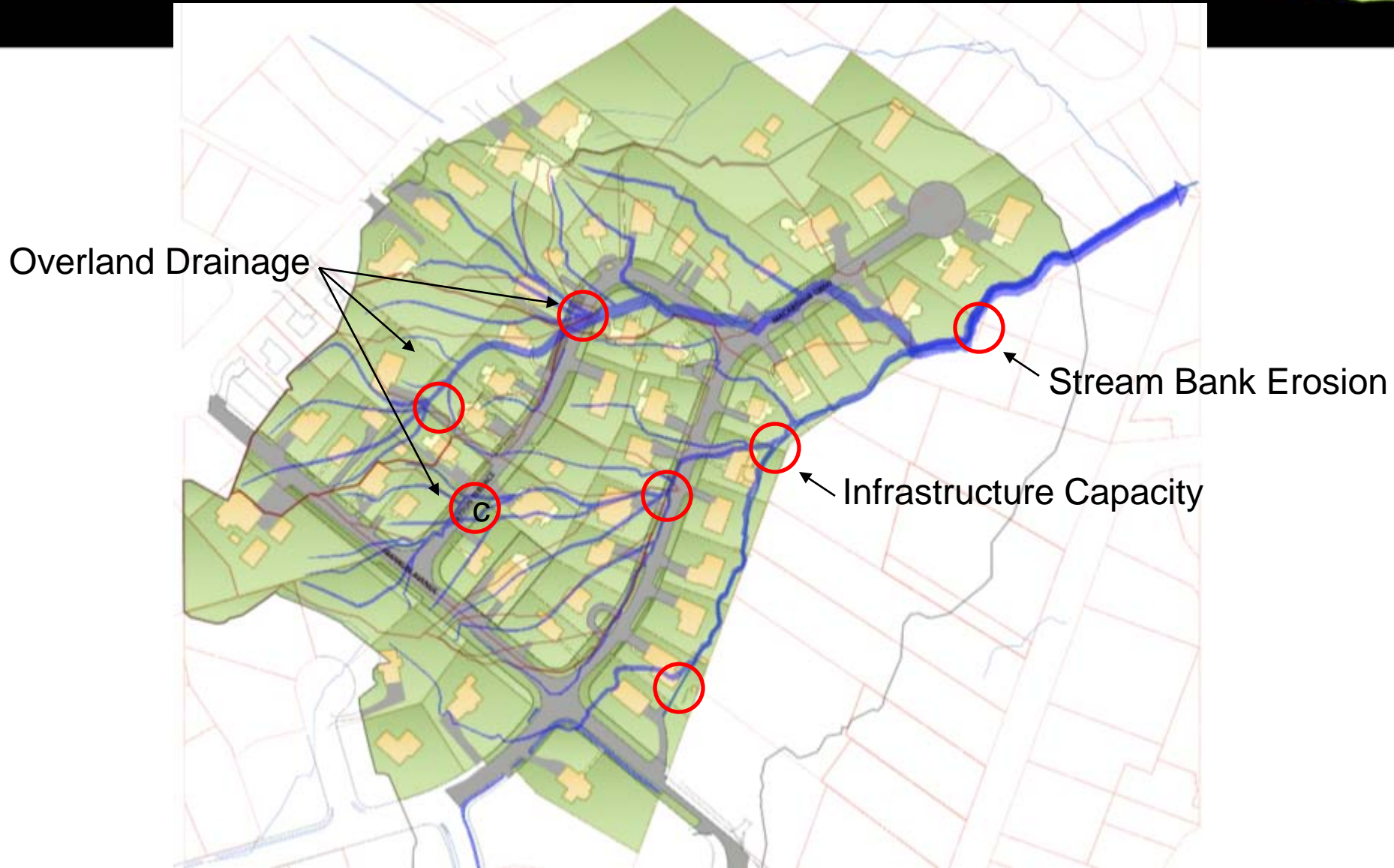



Rendering Location



Patton Terrace Rendering



Patton Terrace Rendering

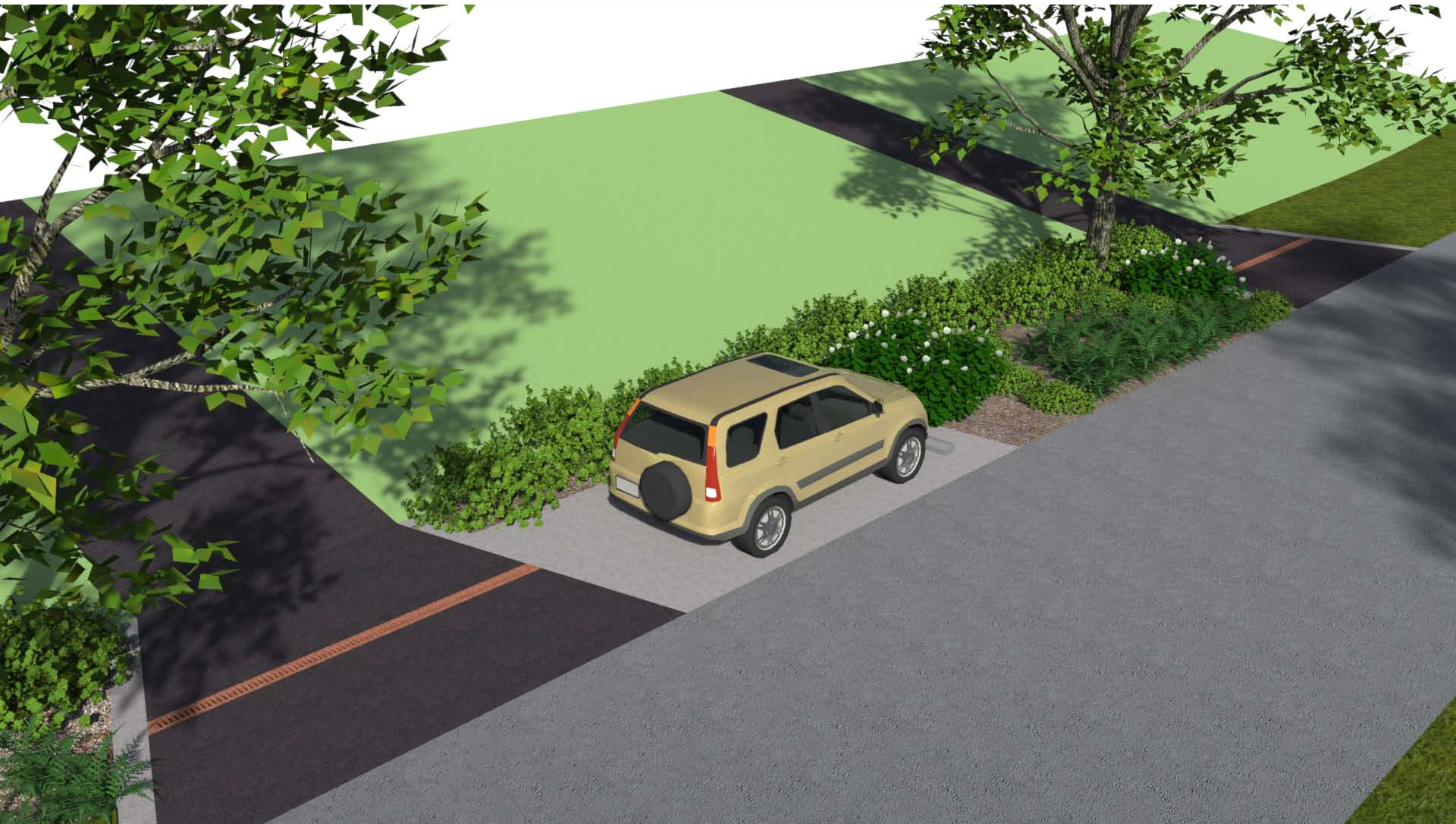

Neighborhood Stormwater Improvement Project

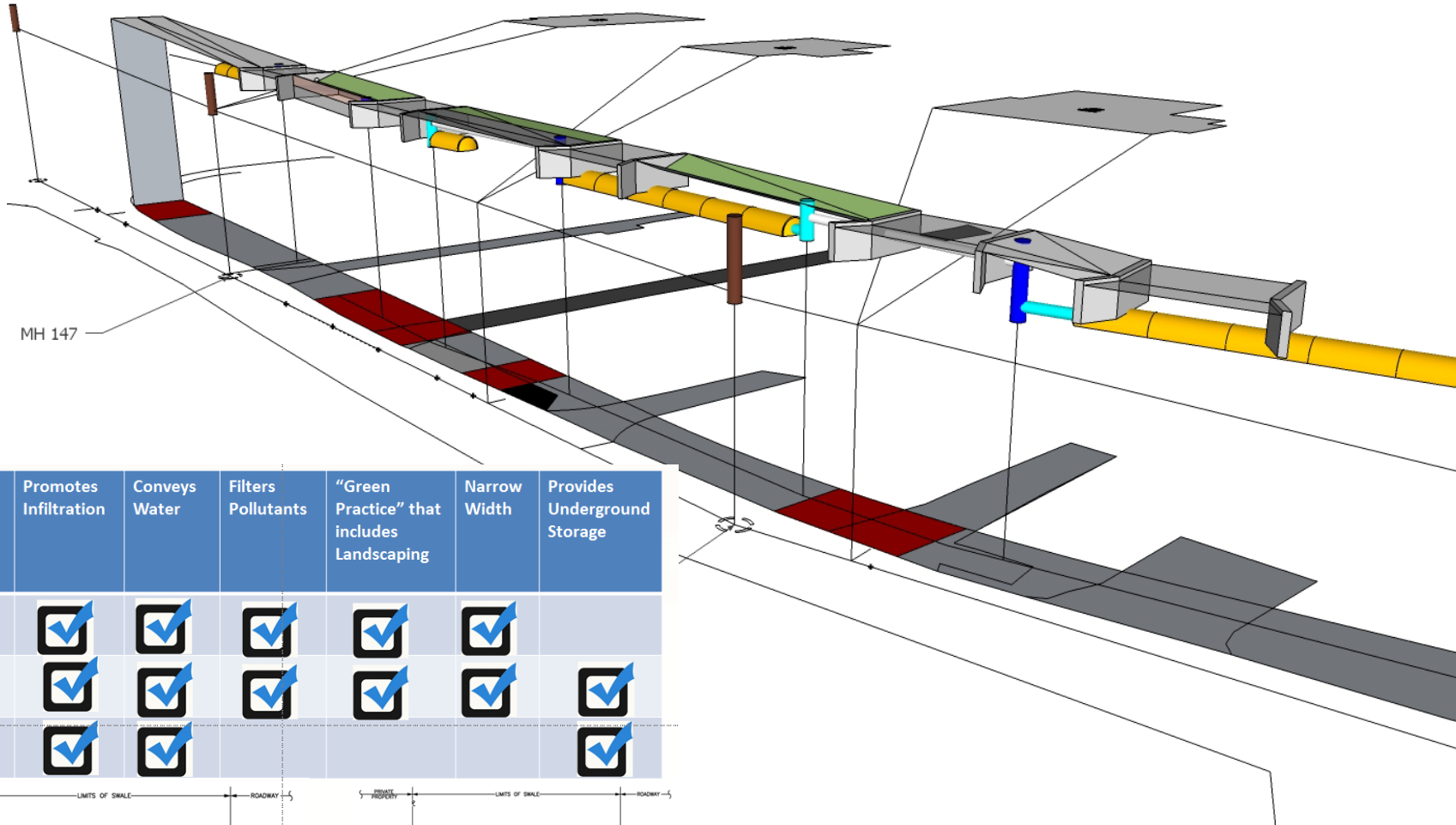

	Promotes Infiltration	Conveys Water	Filters Pollutants	"Green Practice" that includes Landscaping	Narrow Width	Provides Underground Storage
Amended Swale	<input checked="" type="checkbox"/>	<input checked="" type="checkbox"/>	<input checked="" type="checkbox"/>	<input checked="" type="checkbox"/>	<input checked="" type="checkbox"/>	
Infiltration Trench	<input checked="" type="checkbox"/>	<input checked="" type="checkbox"/>	<input checked="" type="checkbox"/>	<input checked="" type="checkbox"/>	<input checked="" type="checkbox"/>	<input checked="" type="checkbox"/>
Permeable Pavements	<input checked="" type="checkbox"/>	<input checked="" type="checkbox"/>				<input checked="" type="checkbox"/>

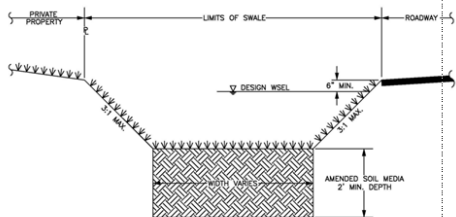

AMENDED SWALE
NTS

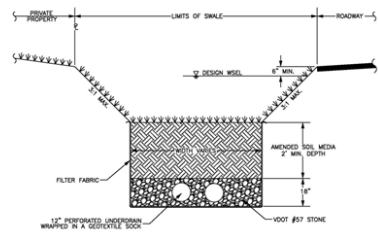

INFILTRATION SWALE
NTS

Indian Run: Stream Restoration and Green Street Project

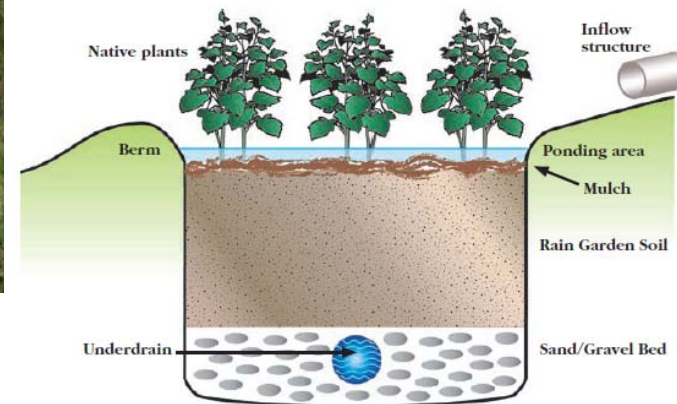

Tyson's Corner Comprehensive Plan

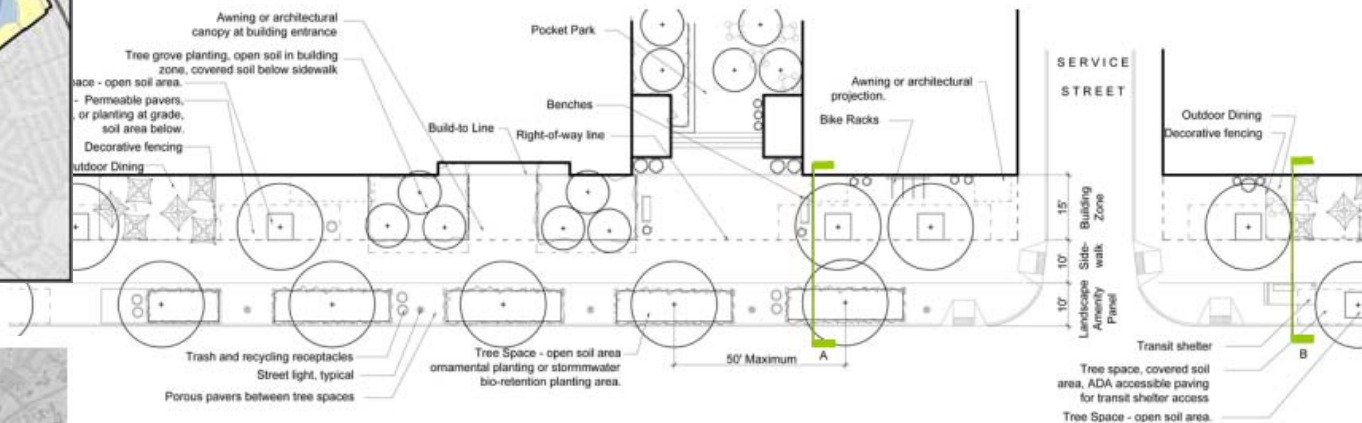
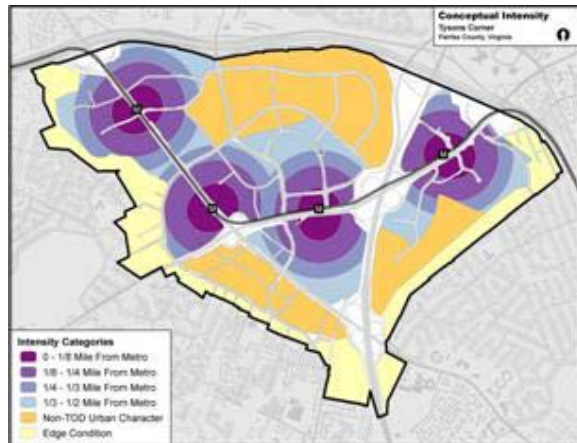

Note: All measurements shown are from back of curb.



Streetscape Example - Plan

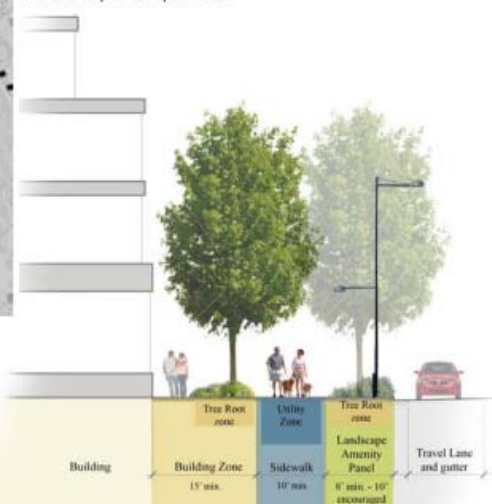

Boulevard Streetscape Example - Section A

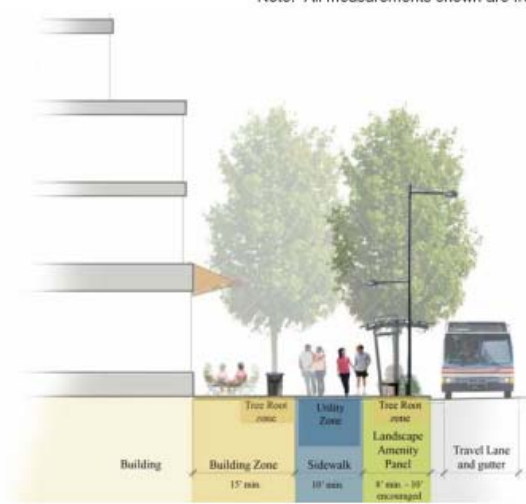

Boulevard Streetscape Example - Section B

Future Green Street Considerations



- Partnerships
- Techniques
- Cost - Benefit
- Operation and Maintenance
- Stormwater Ordinance