



*The District of Columbia's
Message to Property Managers*

Presented by Russell Klein 12/6/12





DISTRICT OF COLUMBIA
dpw
DEPARTMENT OF PUBLIC WORKS
"The Preferred Choice"

♻️ ?







The Solid Waste Multi-Material Management and Recycling Act of 1989

§ 8-1007. Mandatory source separation program [Formerly § 6-3407]

(a) By October 1, 1989, owners and occupants of commercial property shall separate from their solid waste, bundle or containerize, and provide for the recycling of all newspaper. In addition, owners and occupants of office buildings, including the District government, shall separate for collection and provide for the recycling of all paper, as required by the Mayor by rules issued pursuant to § 8-1018.

(b) By October 1, 1990, owners and occupants of commercial property shall separate for collection and provide for the recycling of all glass and metal

*formerly DC ST § 7-226
now DC ST § 8-1001*



Requirements for Commercial Businesses

- ☛ **Separate** mandated materials from solid waste.
(2 streams, minimum)
- ☛ **Enclose** all waste/recyclables in rigid containers at point-of-pickup e.g. loading dock / parking lot.
- ☛ **Contract** a registered recycling hauler, visiting at least 2x / month.
- ☛ **Notify** staff, tenants and guests on annual basis
- ☛ **Post** informational signs at points of collection
- ☛ **Pass** Site Inspection

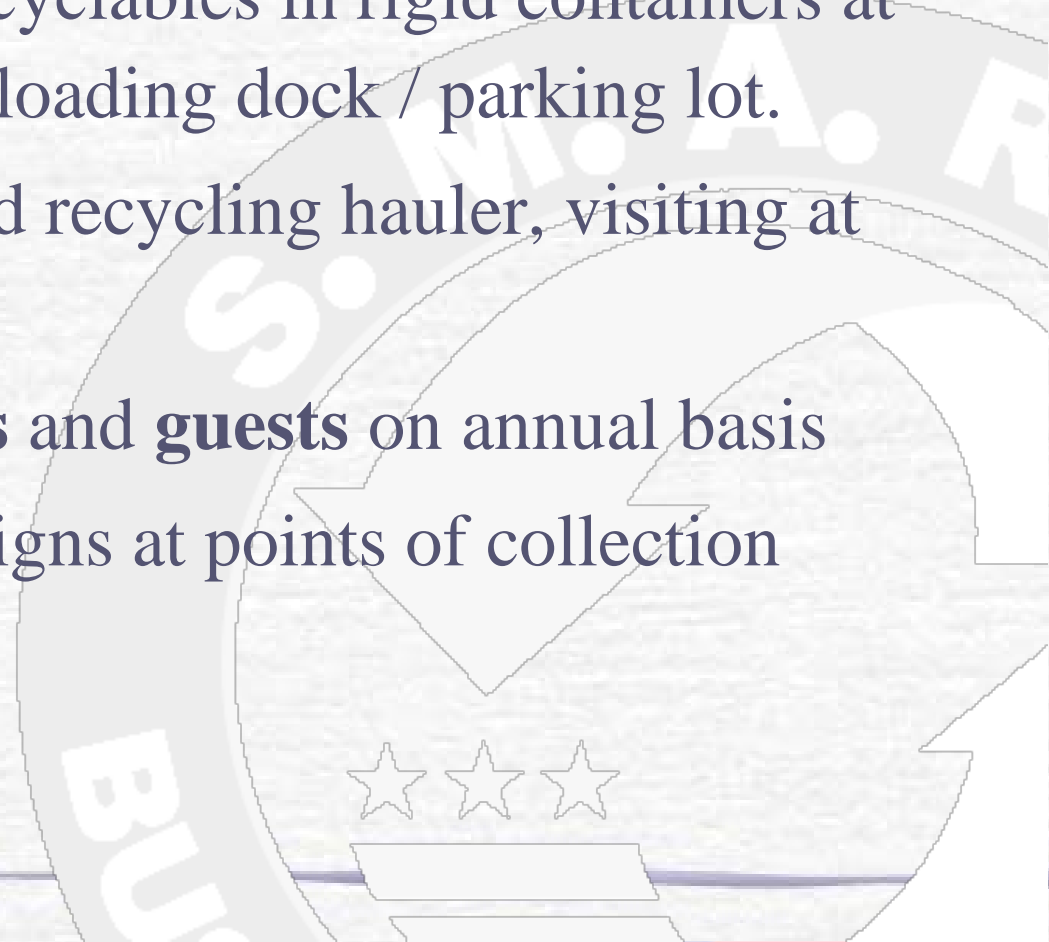

Every Business Must Know...

Enforcement

Issues which may draw a Notice of Violation:

- ❏ Failure to arrange for proper removal of recyclables.
- ❏ Failure to maintain containers for recyclables.
- ❏ Failure to notify tenants/occupants of recycling requirements and program.
- ❏ Failure to post recycling signs.
- ❏ Failure to separate recyclables from other solid waste.
- ❏ Insufficient collection of recyclables (ie. < 2x per month).
- ❏ Failure to have a sufficient number of containers for separated recyclables.



Every Business Must Know...

Fine Schedule *(Tiered, ie. 1st, 2nd 3rd)*

1 st	Offense	\$200
2 nd	Offense (within 60 days)	\$600
3 rd	Offense (within 60 days)	\$1,500

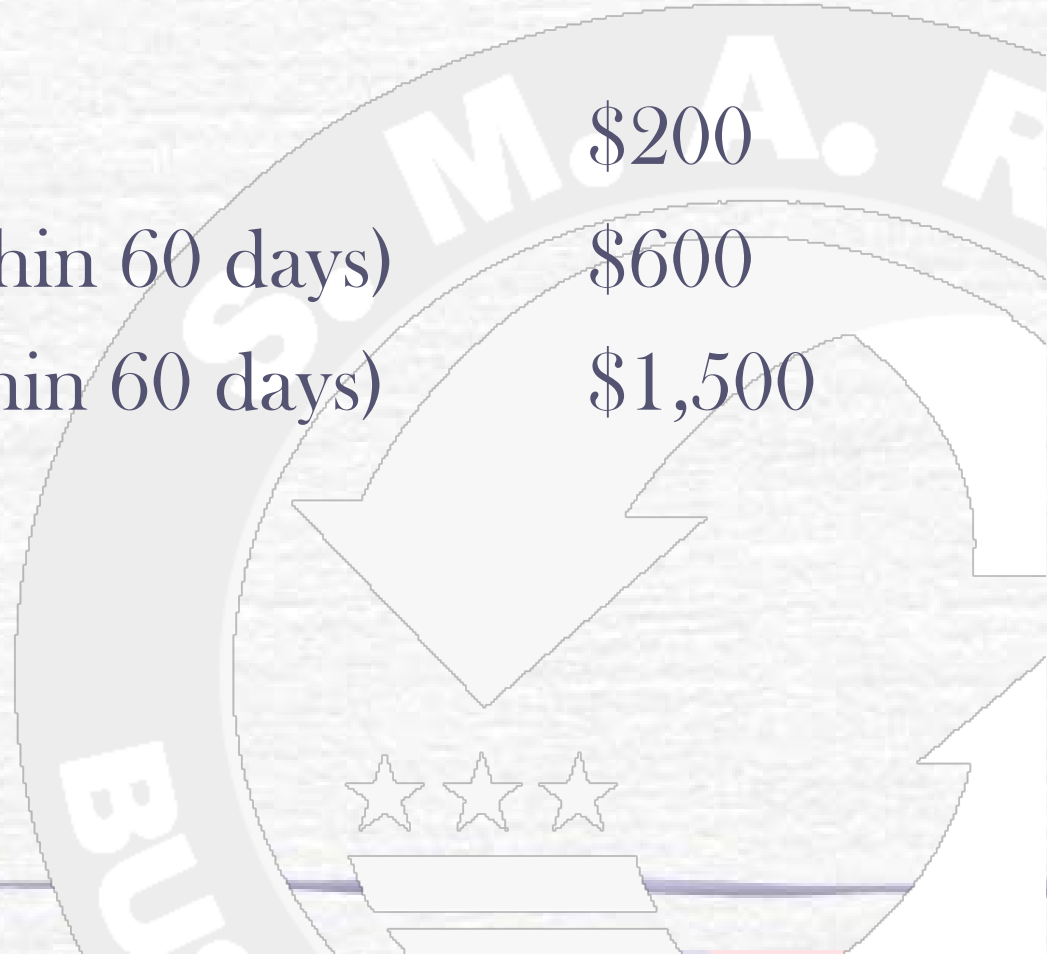

A spiral-bound notebook with a white cover and a light blue lined page. The page has a red margin line on the left and three hole punches. The text "#1" is written in a large, bold, red, handwritten-style font. Below it, the word "Awareness" is written in a smaller, red, serif font. The notebook is centered in the frame against a blurred background of a modern building interior with large windows and columns.

#1

Awareness

Awareness

~~Marketing~~

~~Consumer/Reg. Affairs~~

~~LEED~~

SWEEP Enforcement

Bus. Assoc. Partnerships

'Green Consciousness'

GoRecycle.org

DPW.dc.gov

A spiral-bound notebook with a white cover and lined pages is centered in the image. The notebook is open to a page with horizontal blue lines and a vertical red margin line on the left. The text "#2" is written in a large, bold, red, cursive font. Below it, the words "Physical" and "Resources" are written in a smaller, red, serif font, stacked vertically. The notebook is set against a blurred background of a modern office interior with glass walls and ceiling lights.

#2

Physical
Resources

Phys. Resources

Hauling

Containers

Stickers

Posters

General Information Flyer

A spiral-bound notebook with a white cover and lined pages is centered in the image. The notebook is open to a page with horizontal blue lines and a vertical red margin line on the left. The text "#3" is written in a large, bold, red, cursive font in the center of the page. Below it, the word "Mastery" is written in a smaller, red, serif font. The notebook is set against a blurred background of a school hallway with yellow walls and a ceiling light fixture.

#3

Mastery

Mastery

Tech. Assist. to Prop Mgr

Tenant Rep. Presentations

Employee Presentations

Housekeeping Present.

Hauler Consultations

Commercial Rec. Guide

A spiral-bound notebook with a white cover and lined pages is centered in the image. The notebook is open to a page with horizontal blue lines and a vertical red margin line on the left. The text "#4" is written in a large, bold, red, handwritten-style font in the center of the page. Below it, the word "Ownership" is written in a smaller, red, serif font. The notebook is set against a blurred background of a modern office interior with large windows and a glass partition.

#4

Ownership

Le Building

STAKEHOLDERS

- Tenants
- Guests
- Employees
- Housekeeping
- Physical Plant



COMMON ERRORS

- Bin Placements suboptimal
- Bins Labels suboptimal
- Recyclables Unclear
- Preparations Steps Unclear
- Housekeeping Cross-Mix
- Dumpsters Over/Under-Labeled
- Haulers Mixing Loads

Sustainability Requires Feedback

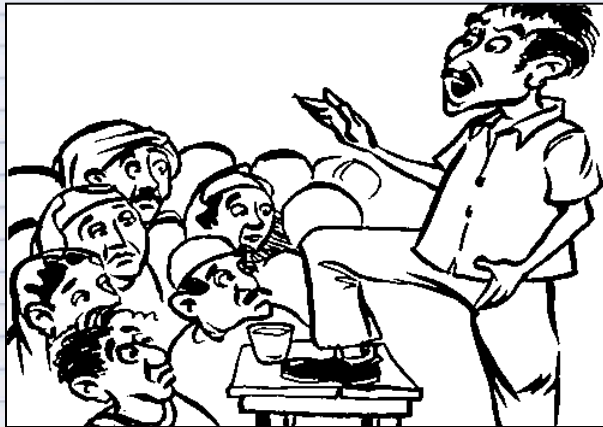

Vs.



Lone Champion

- Tree Hugger
- CEO
- “Dolores in Accounting”

Stakeholder Team

- Property Managers
- Physical Plant
- Housekeeping
- Tenant Reps

Sustainability Requires Feedback



Values



Opportunity



Resistance

Credit: National Recycling Coalition

'Uncovering the Drivers of Consumer Recycling Behavior,' 2007

Sustainability Requires Feedback

Context



Mastery



Access

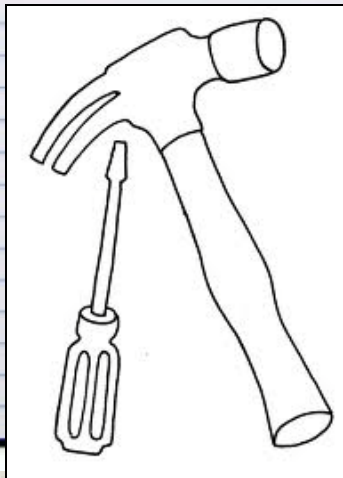

Opportunity

Sustainability Requires Ownership



Receptacles

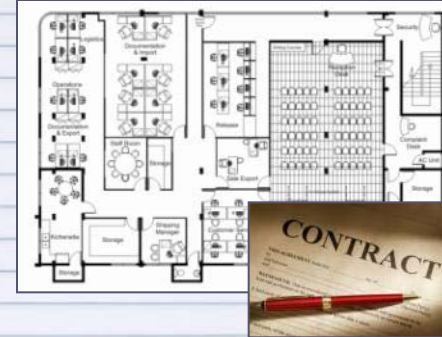

Collection



Signs & Labels



Training
(Where/How/Etc.)

Shared Ownership

- Representative System
- Distributed Ownership
- Peer Pressure

*Solicit Continued Feedback!
Monitor, Measure and Report
out Results!*



Receptacles



Signs & Labels



Collection



Training
(Where/How/Etc.)

Russell Klein

Community Environmental Education Specialist
D.C. Public Works Department
2800B New York Ave, NE
Washington, DC 20020

Recycling Hotline
202-645-8245

Russell.Klein@dc.gov
www.recycle.dpw.dc.gov
www.Facebook.com/TheMRSI



The Preferred Choice

