

Crystal City/Potomac Yard Transitway

MWCOG Regional Bus Subcommittee
June 25, 2013



Route 1 Transitway

- 5-mile corridor between Pentagon City and Braddock Road Metrorail stations
- 80% of corridor in dedicated right-of-way
- 30 Transitway stops within the corridor
- Expected daily ridership of 3,570 by 2017
- First 0.8 mile segment in Alexandria currently under construction
 - Funded by \$8.5M TIGER grant and other state/federal grants
 - Construction began in Summer 2012
 - Substantial completion Dec 2013
 - Begin service in Spring/Summer 2014
- Arlington County construction expected to begin Fall 2013

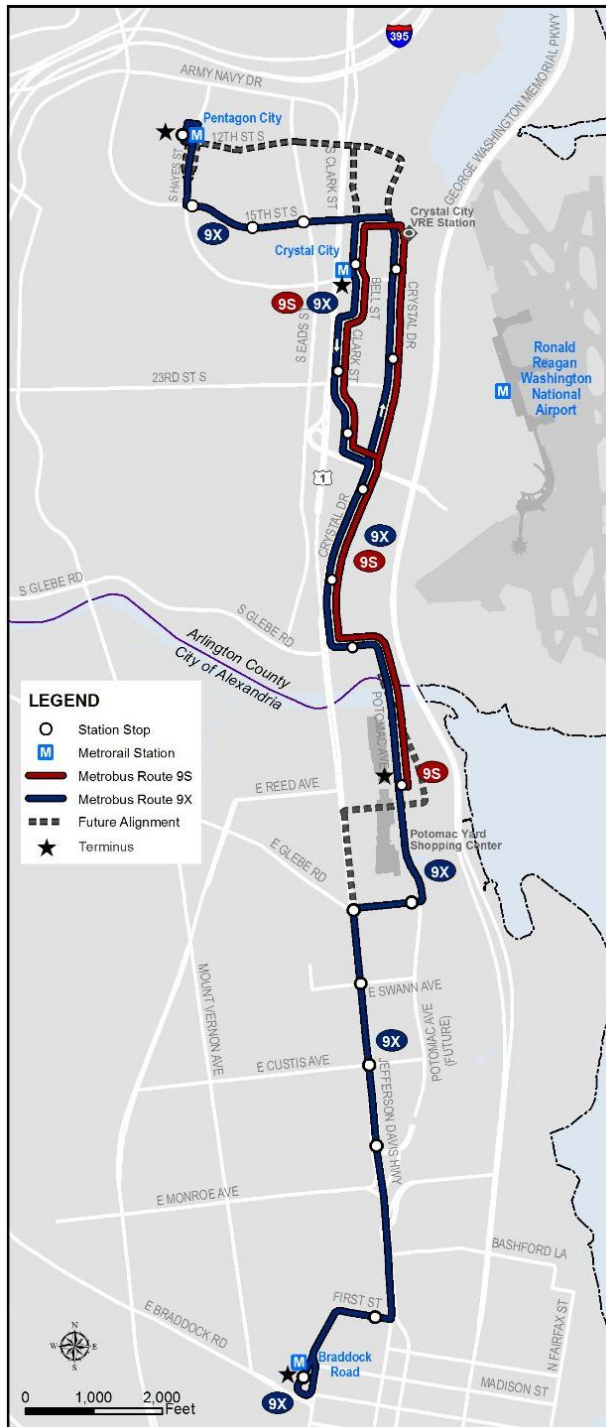

Arlington County Segment

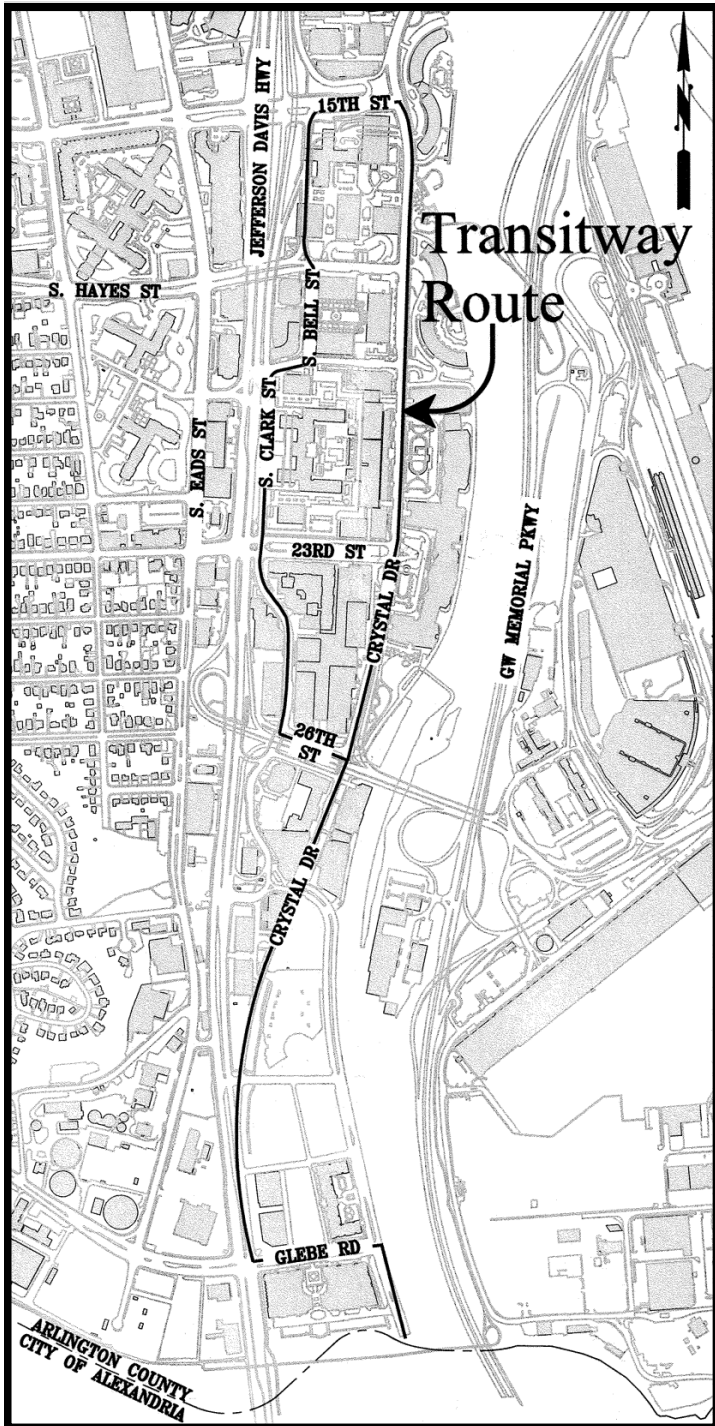

- ROW dedicated through site plan approval process
- Exclusive 24-ft transit only roadway through Potomac Yard
- Dedicated lanes in Crystal City
- Interim connection to Pentagon City via 15th Street; ultimately on 12th Street
- Provisions for converting to streetcar operations in the future

City of Alexandria Segment



- Route 1 northbound widened by Potomac Yard South Developer
- Northbound lanes relocated to the east
- New median (former northbound lanes) to be repurposed for transitway
- 2-lane transit-only corridor with 12-ft landscaped medians on both sides
- Medians taper to allow for left-turn lanes at signalized intersections

Transitway Amenities

- Frequent, reliable service
- Dedicated right-of-way
- Transit signal priority
- Off-board fare collection (proof of payment)
- Real-time information
- Near-level boarding at station platforms
- Boarding at all doors
- Branded bus fleet
- Custom designed shelters and stations

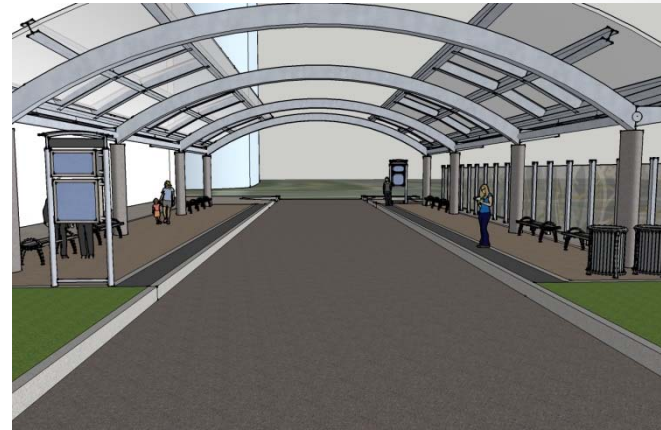

Station/Shelter Design

- Similar shelter design in Arlington and Alexandria
 - Creates unique look/feel throughout corridor
 - Arlington windscreens include Art elements
 - Alexandria will incorporate blue roof, clear windscreen
 - Alexandria will include artistic element in colored concrete at station platform areas in Transitway
- Fare collection equipment and benches within shelter
- Arlington and Alexandria working with WMATA on branded wayfinding signage



Fare Collection Approach

- Proof-of-payment system
 - Time-stamped paper tickets purchased at vending machine (TVM) on platform
 - Passengers board at all doors without showing tickets to operator
 - Inspectors board vehicles or monitor station platforms periodically to inspect tickets
- 3 TVMs per platform
 - 2 SmarTrip-compatible TVMs
 - 1 machine that accepts credit cards/coins



Transitway Operating Plan

Section	Lines	Peak	Off-Peak	Weekend
Pentagon City Station to Crystal City Station	9X	12 min	12 min	15 min
Crystal City Station to South Glebe Road	9S, 9X	6 min	12 min	15 min
South Glebe Road to Braddock Road Station	9X	12 min	12 min	15 min

Span of Service		
Weekdays	5:30 AM	1:00 AM
Saturday	6:30 AM	1:00 AM
Sunday	7:30 AM	11:30 PM

Transitway Management



- Facility and stations owned and managed by City/County
- Off-board fare collection operated and maintained by the City/County
- Use of transitway enforced by City/County
- Other public transit services to request Transitway access from City/County
- Premium bus service operated and supervised by WMATA

Funding – Capital Costs

Arlington County	Federal	State	Local	Total
Transitway	\$4.4M	\$2.6M	\$1.3M	\$8.3M
Stations	\$4.8M	\$3.1M	\$1.6M	\$9.5M
Vehicles	\$0	\$0	\$0	\$0
Total	\$9.2M	\$5.7M	\$2.9M	\$17.8M

Note: The amounts listed above excludes value of land. Cost of vehicles borne by City of Alexandria and WMATA. Estimated (not contracted) costs.

City of Alexandria	Federal	State	Local	Total
Transitway	\$9.8M	\$0.31M	\$0.63M	\$10.8M
Stations	\$3.3M	\$0.48M	\$0.35M*	\$4.1M
Vehicles	\$1.1M	\$0.28M	\$4.0M	\$5.4M
Total	\$14.3M	\$1.1M	\$4.98M	\$20.3M

*Provided through value of land

Branded Bus Fleet

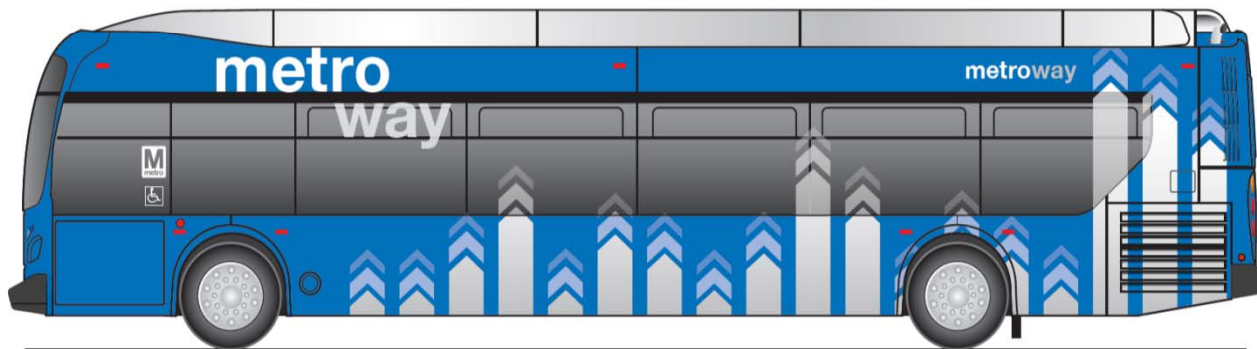
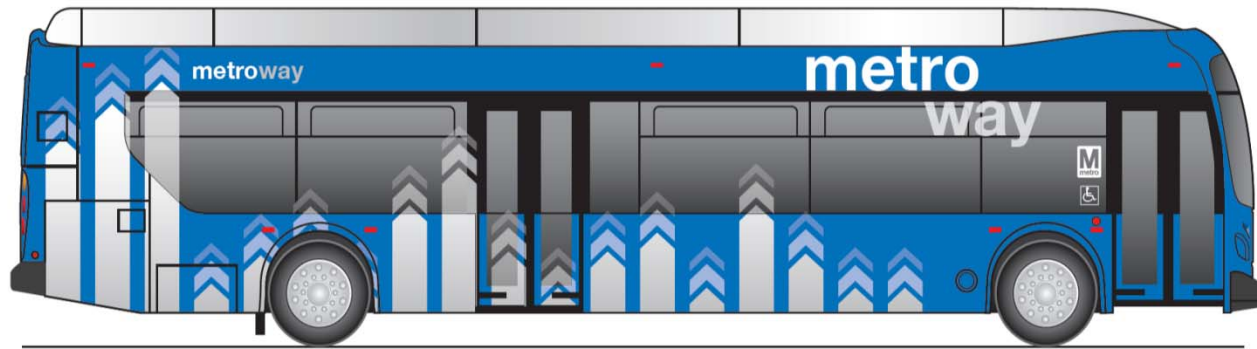

Questions?

www.ccpytransit.com

www.alexandriava.gov/potomacyard

City of Alexandria

Susan Gygi, PE

Potomac Yard Projects Manager

Phone: 703-746-4109

Email: susan.gygi@alexandriava.gov

Arlington County

Matthew Huston, PE

Senior Transit Engineer

Phone: 703-228-3267

Email: mhuston@arlingtonva.us

WMATA

Alison Simon

Director, Customer Research

Phone: 202-962-2442

Email: asimon@wmata.com